

Circuit protection
C120N circuit breakers
 Curves B, C, D

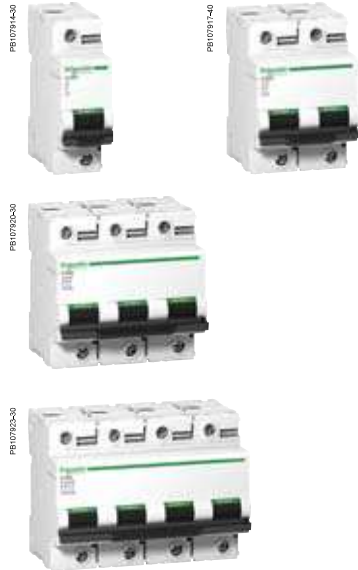

IEC/EN 60898-1

C120N circuit breakers are multistandard circuit breakers that combine the following functions:

- circuit protection against short-circuit currents,
- circuit protection against overload currents,
- suitability for isolation in the industrial sector to IEC/EN 60947-2,
- fault tripping and indication by adding auxiliaries.

Alternating current (AC) 50/60 Hz						
Breaking capacity (Icu) to IEC/EN 60947-2						
Type	Voltage (V)				Service breaking capacity (Ics)	
1P	12 to 130 V	220 to 240 V	380 to 415 V	440 V		
Rating (In) 63 to 125 A	20 kA	10 kA	3 kA ⁽¹⁾	-	75 % of Icu	
2P/3P/4P	12 to 130 V	220 to 240 V	380 to 415 V	440 V	75 % of Icu	
63 to 125 A	-	20 kA	10 kA	6 kA		
Breaking capacity (Icn) to IEC/EN 60898-1						
Type	Voltage (V)				Service breaking capacity (Ics)	
1P, 2P, 3P, 4P	230 to 400 V					
Rating (In) 63 to 125 A	10000 A				75 % of Icn	

⁽¹⁾ One-pole breaking capacity in IT isolated neutral system (double fault).

Direct current (DC)						
Breaking capacity (Icu) according to IEC/EN 60947-2						
Between +/-	Voltage (Ue)					Service breaking capacity (Ics)
	12 to 125 V	≤ 144 V	≤ 250 V	≤ 375 V	≤ 500 V	
Number of poles	1P	2P	3P	4P		100 % of Icu
Rating (In) 63 to 125 A	15 kA	10 kA	10 kA	10 kA	10 kA	

Catalogue numbers

C120N circuit breaker						
Type	1P			2P		
Auxiliaries	Remote indication and tripping, module CA907008 and CA907013			Remote indication and tripping, module CA907008 and CA907013		
Vigi C120	Vigi C120 add-on residual current device, module CA902016			Vigi C120 add-on residual current device, module CA902016		
Rating (In)	Curve			Curve		
	B	C	D	B	C	D
63 A	A9N18340	A9N18356	A9N18378	A9N18344	A9N18360	A9N18382
80 A	A9N18341	A9N18357	A9N18379	A9N18345	A9N18361	A9N18383
100 A	A9N18342	A9N18358	A9N18380	A9N18346	A9N18362	A9N18384
125 A	A9N18343	A9N18359	A9N18381	A9N18347	A9N18363	A9N18385
Width in 9-mm modules	3			6		
Accessories	Module CA907012 and CA907013			Module CA907012 and CA907013		

⁽¹⁾ Country France only

C120N circuit breakers

Curves B, C, D

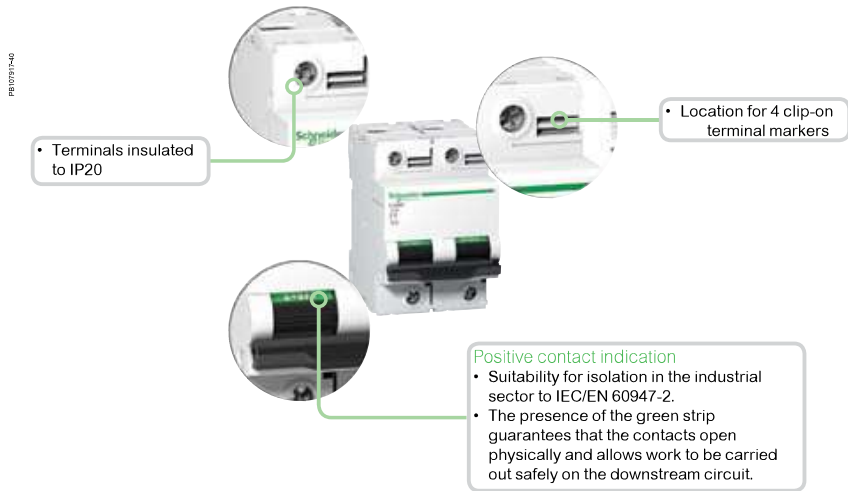

- Longer product service life thanks to:
 - good overvoltage withstand capacity, products designed to offer a high industrial performance level (degree of pollution, rated impulse withstand voltage and insulation voltage).
 - high limitation performances (see limitation curves).
 - fast closure independent of toggle operating speed.
- Remote indication of the open/closed/tripped state by auxiliary contacts (optional).
- Power supply from above or below.

Catalogue numbers

C120N circuit breaker						
Type	3P			4P		
Auxiliaries	Remote indication and tripping, module CA907008 and CA907013			Remote indication and tripping, module CA907008 and CA907013		
Vigi C120	Vigi C120 add-on residual current device, module CA902016			Vigi C120 add-on residual current device, module CA902016		
Rating (In)	Curve			Curve		
	B	C	D	B	C	D
63 A	A9N18348	A9N18364	A9N18386	A9N18352	A9N18371	A9N18390
80 A	A9N18349	A9N18365	A9N18387	A9N18353	A9N18372	A9N18391
100 A	A9N18350	A9N18367	A9N18388	A9N18354	A9N18374 A9N18375(1)	A9N18392
125 A	A9N18351	A9N18369	A9N18389	A9N18355	A9N18376 A9N18377(1)	A9N18393
Width in 9-mm modules	9			12		
Accessories	Module CA907012 and CA907013			Module CA907012 and CA907013		

(1) Country France only

C120N circuit breakers

Curves B, C, D

Connection

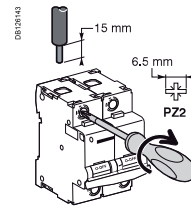

Rating	Tightening torque	Without accessories		With accessories			
		Copper cables Rigid/semi-rigid	Flexible or with ferrule	50 mm ² Al Terminal	Screw-on connection for ring terminal ⁽¹⁾	Multi-cable terminal Rigid cables	Flexible cables
63 to 125 A	3,5 N.m	DB123645	DB123646	DB123635	DB119769	DB119767	
		1,5 to 50 mm ²	1,5 to 35 mm ²	16 to 50 mm ²	Ø 5 mm	3 x 16 mm ²	3 x 10 mm ²

(1) For lugs up to 63 A, front or rear access.

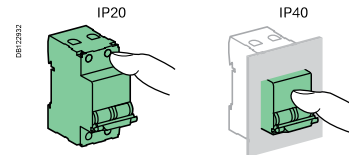
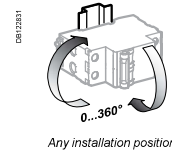
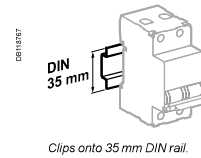

Technical data

Main characteristics			
To IEC/EN 60947-2			
Insulation voltage (Ui)	500 V AC		
Degree of pollution	3		
Rated impulse withstand voltage (Uimp)	6 kV		
Thermal tripping	Reference temperature	50°C	
To IEC/EN 60898-1			
Magnetic tripping	Curve B	3 and 5 In	
	Curve C	5 and 10 In	
	Curve D	10 and 14 In	
Limitation class	3		
Additional characteristics			
Degree of protection (IEC 60529)	Device only	IP20	
	Device in a modular enclosure	IP40	
Endurance (O-C)	Electrical	63 A	10000 cycles (O-C)
		80...125 A	5000 cycles (O-C)
	Mechanical	20000 cycles	
Operating temperature	-30°C to +70°C		
Storage temperature	-40°C to +80°C		
Tropicalisation (IEC 60068-1)	Treatment 2 (relative humidity 95 % at 55°C)		

Weight (g)

Circuit breaker	
Type	C120N
1P	205
2P	410
3P	615
4P	820

Dimensions (mm)

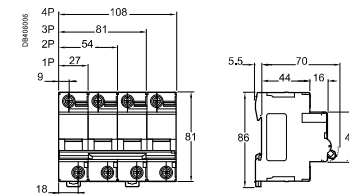

C120H circuit breakers

Curves B, C, D



IEC/EN 60898-1

C120H circuit breakers are multistandard circuit breakers that combine the following functions:

- circuit protection against short-circuit currents
- circuit protection against overload currents
- suitability for isolation in the industrial sector to IEC/EN 60947-2
- fault tripping and indication by adding auxiliaries.

Alternating current (AC) 50/60 Hz

Breaking capacity (Icu) to IEC/EN 60947-2						
Type	Voltage (V)					Service breaking capacity (Ics)
	12 to 130 V	220 to 240 V	380 to 415 V	440 V		
1P	63 to 125 A	30 kA	15 kA	4,5 kA ⁽¹⁾	-	50 % of Icu
2P, 3P, 4P	63 to 125 A	12 to 130 V	220 to 240 V	380 to 415 V	440 V	50 % of Icu
		30 kA	15 kA	10 kA		
Breaking capacity (Icn) to IEC/EN 60898-1						
Type	Voltage (V)					Service breaking capacity (Ics)
	230 to 400 V					
1P, 2P, 3P, 4P	63 to 125 A	15000 A				50 % of Icn

(1) One-pole breaking capacity in IT isolated neutral system (double fault).

Direct current (DC)

Breaking capacity (Icu) according to IEC/EN 60947-2						
Between +/-	Voltage (Ue)					Service breaking capacity (Ics)
	12 to 125 V	≤ 144 V	≤ 250 V	≤ 375 V	≤ 500 V	
Number of poles	1P		2P	3P	4P	
Rating (In) 63 to 125 A	20 kA	15 kA	15 kA	15 kA	15 kA	100 % of Icu



- Longer product service life thanks to:
 - good overvoltage withstand capacity: products designed to provide a high industrial performance level (degree of pollution, rated impulse withstand voltage and insulation voltage).
 - high limitation performances (see limitation curves).
 - fast closure independent of toggle operating speed.
- Remote indication of the open/closed/tripped state by auxiliary contacts (optional).
- Power supply from above or below.

C120H circuit breakers

Curves B, C, D

Catalogue numbers

C120H circuit breaker												
Type	1P			2P			3P			4P		
Auxiliaries	Remote indication and tripping, module CA907008 and CA907013			Remote indication and tripping, module CA907008 and CA907013			Remote indication and tripping, module CA907008 and CA907013			Remote indication and tripping, module CA907008 and CA907013		
Vigi C120	Vigi C120 add-on residual current device, module CA902016			Vigi C120 add-on residual current device, module CA902016			Vigi C120 add-on residual current device, module CA902016			Vigi C120 add-on residual current device, module CA902016		
Rating (In)	Curve			Curve			Curve			Curve		
	B	C	D	B	C	D	B	C	D	B	C	D
63 A	A9N18401	A9N18445	A9N18489	A9N18412	A9N18456	A9N18500	A9N18423	A9N18467	A9N18511	A9N18434	A9N18478	A9N18522
80 A	A9N18402	A9N18446	A9N18490	A9N18413	A9N18457	A9N18501	A9N18424	A9N18468	A9N18512	A9N18435	A9N18479	A9N18523
100 A	A9N18403	A9N18447	A9N18491	A9N18414	A9N18458	A9N18502	A9N18425	A9N18469	A9N18513	A9N18436	A9N18480	A9N18524
125 A	A9N18404	A9N18448	A9N18492	A9N18415	A9N18459	A9N18503	A9N18426	A9N18470	A9N18514	A9N18437	A9N18481	A9N18525
Width in 9 mm modules	3			6			9			12		
Accessories	Module CA907012 and CA907013			Module CA907012 and CA907013			Module CA907012 and CA907013			Module CA907012 and CA907013		